

13

PAGE 1

3 PAGES



2719 South Hwy 585
 P.O. Box 1352
 Sundance, Wyoming 82729
 Phone: 307-283-2221
 Fax: 307-283-1450

February 3, 2009

Todd and Judith Bush
 2313 County Rd 64
 RR2 Carrying Place
 Ontario, Canada KDK - ILO

RE: Surface ownership near Rifle Pit Road

Dear Mr. and Mrs. Bush:

Per your discussion with Roger Croell, we must obtain Surface Landowner's Consent for the state of Wyoming in order to cross your property at the entrance of our quarry. I have enclosed a map for your review and also the form required by the state. Please complete the form and mail back at your earliest convenience.

Please feel free to contact me at the above address if you have any questions or concerns.

Sincerely,

Julie Ewing
 Croell Redi-Mix, Inc.
 Health and Safety Director

Encl.



CROELL QUARRY

#13 PAGE # 2

E1/2NW1/4 AND THE NE1/4SW1/4 OF SECTION 25, T.52N.,
R.82W. OF THE SIXTH PRINCIPAL MERIDIAN, CROOK COUNTY,
WYOMING

DISTURBED AREA EXCEPTING DESIGNATED ROADS = 13.2 ACRES

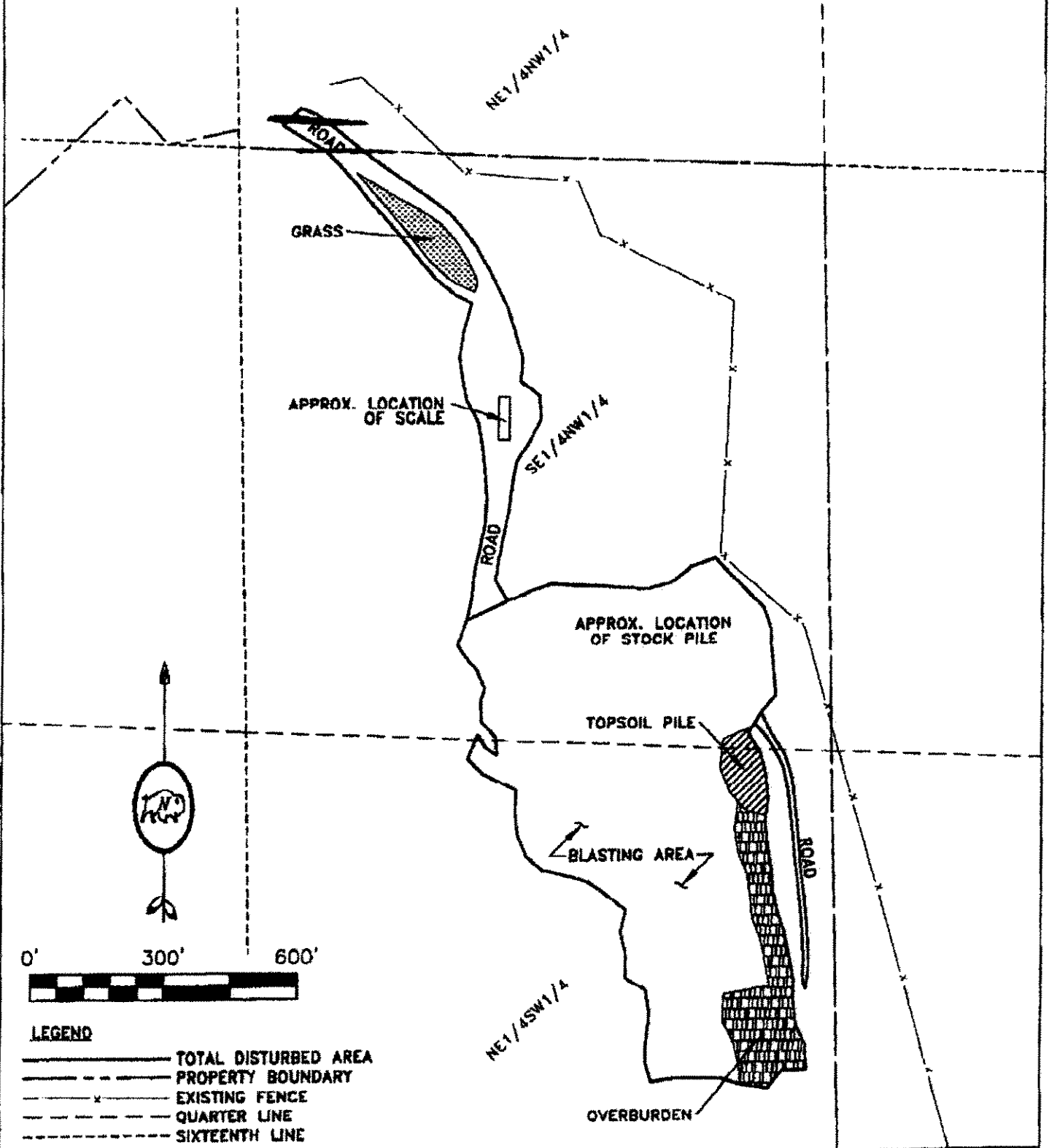

- LEGEND**
- TOTAL DISTURBED AREA
 - PROPERTY BOUNDARY
 - - - - - EXISTING FENCE
 - - - - - QUARTER LINE
 - - - - - SIXTEENTH LINE

Do not make corrections to this form after printing. Forms bearing strikeouts, ink changes, etc will not be accepted.

SURFACE LANDOWNER'S CONSENT

I, Todd and Judith Bush, et al, CERTIFY that I hold surface rights on the following lands on which Croell Redi-Mix, Inc. holds mineral estate rights:

<u>S1/2, SW, NE, NW</u> Section <u>25</u>	T. <u>52</u> N.	R. <u>62</u> W.
Section _____	T. _____ N.	R. _____ W.
Section _____	T. _____ N.	R. _____ W.
Section _____	T. _____ N.	R. _____ W.
Section _____	T. _____ N.	R. _____ W.
Section _____	T. _____ N.	R. _____ W.
Section _____	T. _____ N.	R. _____ W.

County of Crook

I have examined the mining plans and reclamation plan prepared by Croell Redi-Mix, Inc. in compliance with the Wyoming ENVIRONMENTAL QUALITY ACT, and do hereby approve said plans, and give my consent to enter and carry out said mining and reclamation programs on said lands as proposed therein.

Dated this _____ day of Feb, 2009

Surface Landowner (Signature)

Todd and Judith Bush, et al
Name (printed or typed)

(Witness)

(Date)

Form 8
Rev. 10/99