

FILED

OCT 29 2010

Jim Ruby, Executive Secretary
Environmental Quality Council

Exhibit 16

**EQC Docket 10-2803
Judith Bush**

Croell Redi-Mix Application AP 5468

I am including DEQ AQD records of all Croell Redi-Mix Applications to date relating to that company's mining operations at its Rogers Rock Pit Location.

I am including them in chronological order.

AP 5468 is the initial application for Air Quality permits relating to its LMO Permit 1396 ET. It was approved as CT-4526(the AQD mine permit) and CT-4527 (the AQC crusher / operator permit)

This application is for a mine permit for a 10 acre minesite with a maximum production of 100,000 tons / year.

I am including AQD documentation of these various permits because I do not believe that it is the intent of the Environmental Quality Act that permits subsequent to CT-4526 and CT-4527 should have been issued under the AQD mine permit CT-4526.

note The legal description on all of the following AQD permits
(the NWNE of Section 25 T52N R 62W) is incorrect.



STATE OF WYOMING
Department of Environmental Quality - Air Quality Division
Mining/Quarry Operations - Non Coal
Permit Application Form



(Submit three (3) copies of the complete application)

Company Name: Cordell Ledi Mix Inc.
Contact: Julie Ewing Title: Health + Safety Director
Mailing Address: PO BOX 1352
City: Jordan State: WY Zip: 82729
Phone: 307-283-2221 Fax: 307-283-1450 E-Mail: cordell_julie@rangeweb.net

Mine Name: Roger's Rock Pit
Size of Mine: 10 Acres
Legal Description: 1/4: N1/4 1/4: N6 Section: 25 T: 52 N R: 62 W
Latitude: _____ Longitude: _____
County: Crook

Number of residences within 1 mile radius: 1 Distance to nearest residence: 1 mile

Type of Material Mined (This form is Not for Coal Mines): Limestone
Total Material Available: 2 million Tons Max Annual Production: 100,000 Tons per year
Hours of Operation: 10 Hours/day 5 Days/week 20 Weeks/year

Equipment/Operations planned at this site: Crushing * Screening * Hot Mix Plant *
(mark all that apply) Wet Screening * Stock Piling Blasting Concrete Batch Plant *
* Operation of crushers, screens, hot mix asphalt plants or concrete batch plants at the quarry will only be allowed if so designated on this application. Note: Any crushers, screens, hot mix asphalt plants, or concrete batch plants must have a separate, valid air quality permit.

Brief Process Description: Blast Limestone, crush + screen material + stockpile material, material is then hauled to our plants to make concrete

- All applications must include:
1. Documentation that the proposed site is located in accordance with proper land use planning as determined by the appropriate state or local agency charged with such responsibility. (Per Chapter 6, Section 2(c)(iv) of the WAQSR.)
 2. A map identifying the site location and mining activities (for operations 10 acres or less) or a mine plan (for operations more than 10 acres). The mine plan from the Land Quality Division (LQD) application [Item 9 on LQD Form 1(s)] may be used. A reclamation plan is not required.
 3. Completed Attachments A, B, and C (Forms MN-2, MN-3, and MN-4).

1. Julie Ewing Responsible Official Title: Health + Safety Director

state that I have knowledge of the facts herein set forth and that the same are true and correct to the best of my knowledge and belief. I further certify that the maximum production rate listed in this application reflects the maximum anticipated production rate listed in this application reflects the maximum anticipated production rate at this quarry. The facility will operate in compliance with all Wyoming Air Quality Standards and Regulations.

Signature: Julie Ewing Date: 10/17/00



STATE OF WYOMING
 Department of Environmental Quality - Air Quality Division
 Chapter 6, Section 2 Permit Application
 Mining/Quarry Operations - Non Coal
 Attachment A - Mined Material Information



Disturbed/Open Acreage

Acreage Subject to Wind Erosion: ~8 Acres

Topsoil

Removal Equipment: Dozer + Loader

Tons/day Removed: 500 Tons/year Removed: 2,000

Fugitive Particulate Control Method: Water

Control Application Frequency: as needed

Topsoil Stockpiles - No of Piles: 4 Size of Piles (tons or yd³): 500T

Stockpile Fugitive Control Method: Water

Control Application Frequency: as needed

Overburden

Removal Equipment: Dozer + Loader

Tons/year Removed: 5,000

Fugitive Particulate Control Method: Water

Control Application Frequency: as needed

Overburden Stockpiles - No of Piles: 4 Size of Piles (tons or yd³): 1250T

Stockpile Fugitive Control Method: Water

Control Application Frequency: as needed

Blasting

Number of Blasts/year: 4

Type of Blasting Agent Used: ANFO Amount of Blasting Agent Used Annually (tons): ~8

Operational Practices used for Emission Control: NONE
(this will be contracted out)

Mined Material

Removal Equipment: Dozer + Loader

Tons/year Removed: 100,000 T

Operational Practices used for Emission Control: Water as needed

Material Stockpiles - No of Piles: 5 Size of Piles (tons or yd³): ~10,000

Stockpile Fugitive Control Method: Water

Control Application Frequency: as needed



STATE OF WYOMING
 Department of Environmental Quality - Air Quality Division
 Crushing/Screening Operations
Permit Application Form



(Please submit three (3) copies of the complete application)

Company Name: Croell Bedi mix inc.
 Contact: Julie Ewing Title: Health + Safety Director
 Mailing Address: PO Box 1352
 City: Sundance State: WY Zip: 82729
 Phone: 307-283-2221 Fax: 307-283-1450 E-Mail: croell_julie@orangeweb.net

Initial Location
 Legal Description: 1/4: NW 1/4: NE Section: 25 T: 52 N R: 62 W
 Latitude: _____ Longitude: _____
 County: Crook

Existing Pit/Quarry: Yes No
 Pit/Quarry Name: _____ Pit/Quarry Owner: _____
 AQD Permit Number: _____

Type of Material Crushed/Screened: Limestone
 Max. Hourly Production: 300 Tons/hr Max. Annual Production: 100,000 Tons per year
 Ave. Hourly Production: 250 Tons/hr
 Hours of Operation: 10 Hours/day 5 Days/week 20 Weeks/year

Equipment/Operation: Crushing Screening
 (mark all that apply) Wet Screening Stock Piling

Is the equipment intended for stationary or portable use: Stationary Portable

- All applications must include:
1. Documentation that the proposed site is located in accordance with proper land use planning as determined by the appropriate state or local agency charged with such responsibility. (Per Chapter 6, Section 2(c)(iv) of the WAQSR.)
 2. A map identifying the location of the site.
 3. A map identifying all haul roads, including county roads and any other unpaved roads, associated with the crushing/screening activities. Please indicate the distance material will be hauled until reaching pavement.
 4. Brief process description with a plot plan depicting site set up with location of controls.

I, Julie Ewing Health + Safety Director
 Responsible Official Title

state that I have knowledge of the facts herein set forth and that the same are true and correct to the best of my knowledge and belief. The facility will operate in compliance with all Wyoming Air Quality Standards and Regulations.

Signature: Julie Ewing Date: 10/17/10



STATE OF WYOMING
 Department of Environmental Quality - Air Quality Division
 Crushing/Screening Operations
 Crusher/Screen Form



Crusher

Primary: Secondary: Tertiary: Other: _____
 (Use additional Crusher/Screen Forms if using more than 2 crushers)

Manufacturer: TELSmith Model #: 30x40 Serial #: 505M1761C56
8716910

Type: Jaw Cone Impact Other Type: _____

Date Manufactured: 1987 Max. Crusher Capacity per Hour: 300 tons

Subject to NSPS - OOO (manufactured after August 1, 1985): Yes No

Crusher

Primary: Secondary: Tertiary: Other: _____
 (Use additional Crusher/Screen Forms if using more than 2 crushers)

Manufacturer: Sandvik Model #: H4B800 Serial #: 441382100

Type: Jaw Cone Impact Other Type: _____

Date Manufactured: 2004 Max. Crusher Capacity per Hour: 300 tons

Subject to NSPS - OOO (manufactured after August 1, 1985): Yes No

Screen

Manufacturer: Cedar Rapids Model #: 6x20 Serial #: 46509

Date Manufactured: 1994 Type: HORIZONTAL

Subject to NSPS - OOO (manufactured after August 1, 1985): Yes No
 (Use additional Crusher/Screen Forms if using more than 2 screens)

Screen

Manufacturer: Cedar Rapids Model #: TSS6203 Serial #: 52059

Date Manufactured: 2005 Type: HORIZONTAL

Subject to NSPS - OOO (manufactured after August 1, 1985): Yes No
 (Use additional Crusher/Screen Forms if using more than 2 screens)

of Conveyor Belts: 15 Number of Transfer/Drop Points: 15

of Stockpiles: 5 Size of Stock Piles: 10,000 tons

Source Control Sources will be controlled as follows:

	No Control	Water Spray	Chemical Dust Suppressant	Other (explain)
Feed hopper	<input type="checkbox"/>	<input type="checkbox"/>	<input type="checkbox"/>	<input checked="" type="checkbox"/> will spray
Transfer Points	<input type="checkbox"/>	<input type="checkbox"/>	<input type="checkbox"/>	<input checked="" type="checkbox"/> Water as needed
Inlet to Crushers	<input type="checkbox"/>	<input type="checkbox"/>	<input type="checkbox"/>	<input checked="" type="checkbox"/>
Outlet of Crushers	<input type="checkbox"/>	<input type="checkbox"/>	<input type="checkbox"/>	<input checked="" type="checkbox"/>
Inlet to Screens	<input type="checkbox"/>	<input type="checkbox"/>	<input type="checkbox"/>	<input checked="" type="checkbox"/>
Outlet of Screens	<input type="checkbox"/>	<input checked="" type="checkbox"/>	<input type="checkbox"/>	<input checked="" type="checkbox"/> cones
Haul Roads	<input type="checkbox"/>	<input checked="" type="checkbox"/>	<input type="checkbox"/>	<input type="checkbox"/> AS needed
Work Areas	<input type="checkbox"/>	<input checked="" type="checkbox"/>	<input type="checkbox"/>	<input type="checkbox"/> AS needed
Stockpiles	<input type="checkbox"/>	<input checked="" type="checkbox"/>	<input type="checkbox"/>	<input type="checkbox"/> AS needed

STATE OF WYOMING
 Department of Environmental Quality - Air Quality Division
 Crushing/Screening Operations
 Generator Form

Generator #1 Information: (Use additional Generator Forms if using more than 2 Generators)
 Manufacturer: Cat Model #: D200P3 Serial #: 200T-63127
 Site Horsepower Rating: 250

Fuel Type:
 Natural Gas LP Gas Diesel Gasoline
 Fuel Consumption (specify units): 100 gal/day Fuel Sulfur Content (specify units): 15 ppm

Emissions Data:

	g/hp-hr	lb/hr	TPY
NO _x	_____	_____	_____
CO	_____	_____	_____
VOC	_____	_____	_____
PM ₁₀	_____	_____	_____
SO _x	_____	_____	_____

Emissions Control:

Lean Burn Other Describe:
 AFRC
 NSCR
 SCR
 Tier I Certified
 Tier II Certified
 Tier III Certified

Generator #2 Information: (Use additional Generator Forms if using more than 2 Generators) N/A
 Manufacturer: _____ Model #: _____ Serial #: _____
 Site Horsepower Rating: _____

Fuel Type: N/A
 Natural Gas LP Gas Diesel Gasoline
 Fuel Consumption (specify units): _____ Fuel Sulfur Content (specify units): _____

Emissions Data: N/A

	g/hp-hr	lb/hr	TPY
NO _x	_____	_____	_____
CO	_____	_____	_____
VOC	_____	_____	_____
PM ₁₀	_____	_____	_____
SO _x	_____	_____	_____

Emissions Control:

Lean Burn Other Describe:
 AFRC
 NSCR
 SCR
 Tier I Certified
 Tier II Certified
 Tier III Certified

Additional Information:

Please use the following hierarchy for determining emissions from generators

1. g/hp-hr emission rates based on manufacturer's information. Provide a copy of the manufacturer's information with the application.
2. g/hp-hr emission rates based on actual test data. Provide a copy of the test report with the application.
3. Emission factors. Documentation from the manufacturer must be provided with the application stating no emission factors are available for the generator before the Division will accept other emission factors such as AP-42.

blasting Area

CONTROL VAN
GEN SET

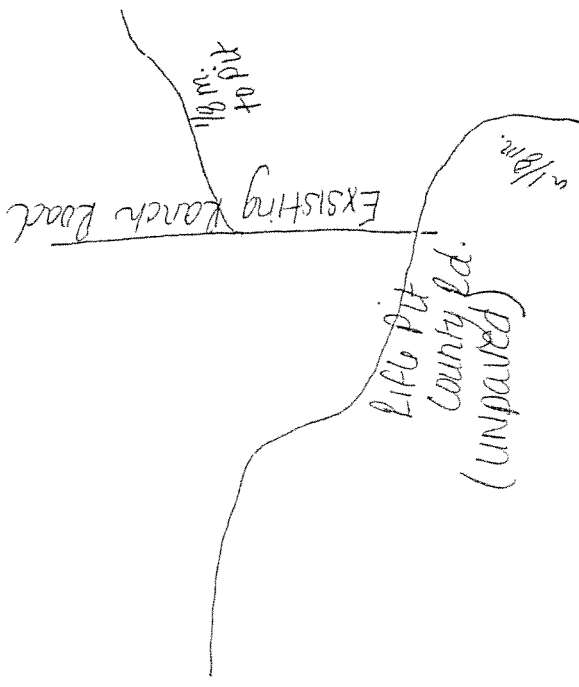
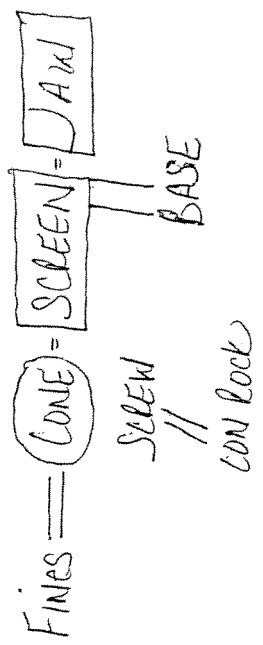

I-90

Frontage Road (Hwy 14)
(paved)



Pit will be located in the NW 1/4 NE 1/4 of SW 1/4 Section 25

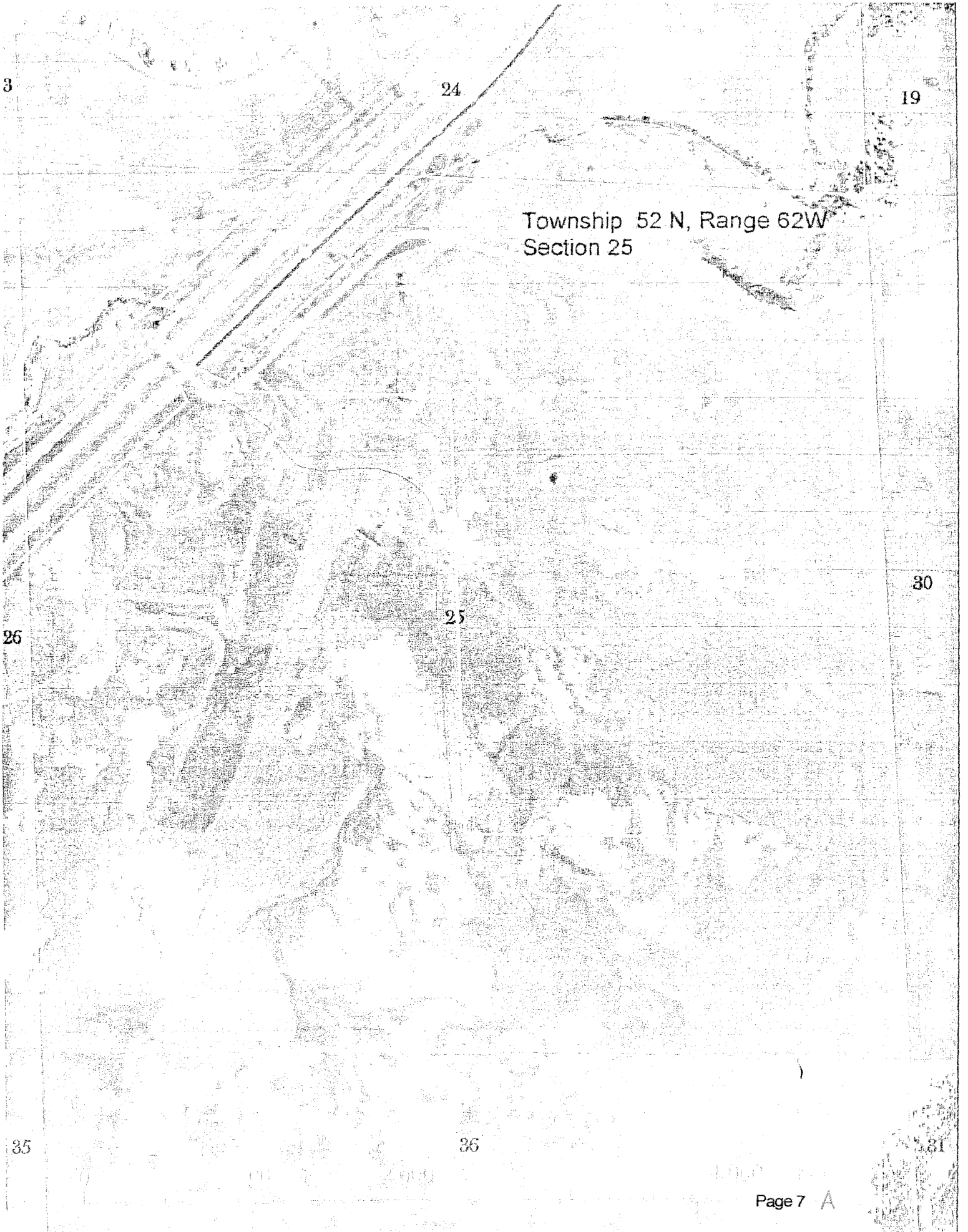

Township 52 N, Range 62W
Section 25

...

APPENDIX A
Facility Location Map

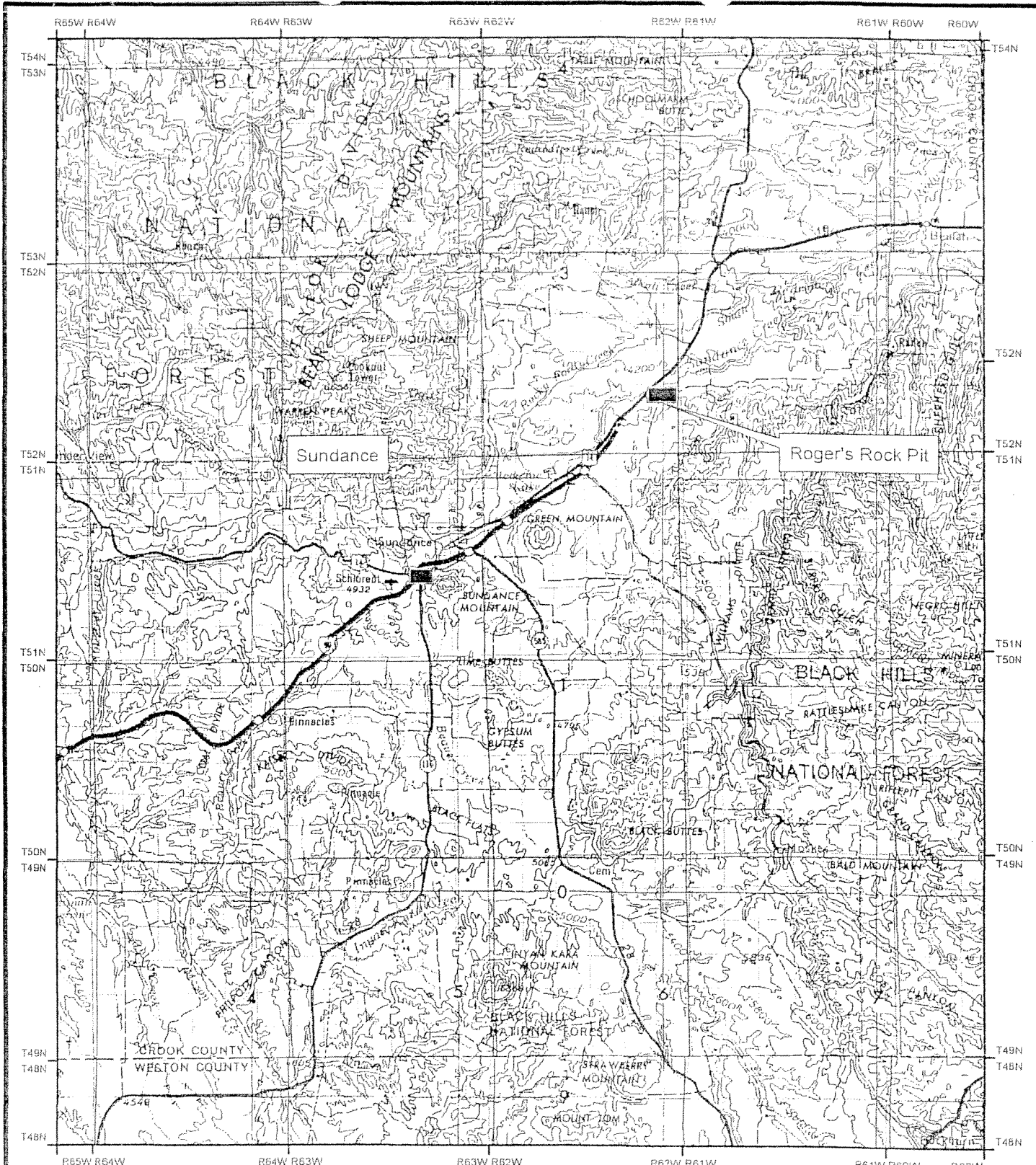

Croell Redi Mix, Inc.

Roger's Rock Pit

NW1/4 NE1/4 of Section 25, T52N, R62W

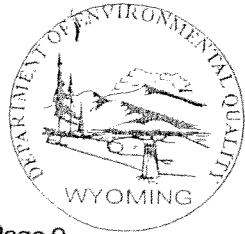
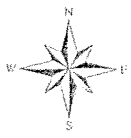

APPENDIX B
Emission Estimates

CRUSHING EMISSIONS:

Based on a 100,000 TPY production rate, TSP and PM₁₀ emissions associated with crushing operations were estimated as follows:

Crushing: 0.0054 lb/ton TSP, 0.0024 lb/ton PM₁₀
AP-42 Table 11.19.2-2 8/04

$$\text{TSP Emissions} = \frac{100,000 \frac{\text{ton}}{\text{year}} \times 0.0054 \frac{\text{lb}}{\text{ton}} \times (1 - 0.50)}{2,000 \frac{\text{lb}}{\text{ton}}} = 0.14 \frac{\text{ton}}{\text{year}} \text{ (50\% control)}$$

$$\text{PM}_{10} \text{ Emissions} = \frac{100,000 \frac{\text{ton}}{\text{year}} \times 0.0024 \frac{\text{lb}}{\text{ton}} \times (1 - 0.50)}{2,000 \frac{\text{lb}}{\text{ton}}} = 0.06 \frac{\text{ton}}{\text{year}} \text{ (50\% control)}$$

SCREENING EMISSIONS:

Based on a 100,000 TPY production rate, TSP and PM₁₀ emissions associated with screening operations were estimated as follows:

Screening: 0.025 lb/ton TSP, 0.0087 lb/ton PM₁₀
AP-42 Table 11.19.2-2 8/04

$$\text{TSP Emissions} = \frac{100,000 \frac{\text{ton}}{\text{year}} \times 0.025 \frac{\text{lb}}{\text{ton}} \times (1 - 0.50)}{2,000 \frac{\text{lb}}{\text{ton}}} = 0.63 \frac{\text{ton}}{\text{year}} \text{ (50\% control)}$$

$$\text{PM}_{10} \text{ Emissions} = \frac{100,000 \frac{\text{ton}}{\text{year}} \times 0.0087 \frac{\text{lb}}{\text{ton}} \times (1 - 0.50)}{2,000 \frac{\text{lb}}{\text{ton}}} = 0.22 \frac{\text{ton}}{\text{year}} \text{ (50\% control)}$$

CONVEYOR TRANSFER POINT EMISSIONS:

Based on a 100,000 TPY production rate, TSP and PM₁₀ emissions associated with fifteen (15) conveyor transfer points were estimated as follows:

Conveyor transfer point: 0.0036 lb/ton TSP, 0.00046 lb/ton PM₁₀
 AP-42 Table 11.19.2-2 8/04

$$\text{TSP Emissions} = \frac{100,000 \frac{\text{ton}}{\text{year}} \times 0.0036 \frac{\text{lb}}{\text{ton}} \times (1 - 0.50)}{2,000 \frac{\text{lb}}{\text{ton}}} = 0.09 \frac{\text{ton}}{\text{year}} \text{ (50\% control) per transfer point}$$

TSP Emissions = 0.09 tpy x 15 transfer points = 1.35 tpy

$$\text{PM}_{10} \text{ Emissions} = \frac{100,000 \frac{\text{ton}}{\text{year}} \times 0.00046 \frac{\text{lb}}{\text{ton}} \times (1 - 0.50)}{2,000 \frac{\text{lb}}{\text{ton}}} = 0.01 \frac{\text{ton}}{\text{year}} \text{ (50\% control) per transfer point}$$

PM₁₀ Emissions = 0.01 tpy x 15 transfer points = 0.15 tpy

TRUCK LOADING AND STOCKPILING EMISSIONS:

Based on a 100,000 tpy of mined material, 2,000 tpy of topsoil, and 5,000 tpy of overburden, TSP and PM₁₀ emissions associated with stockpiling operations were estimated as follows, using AP-42 13.2.4 Equation 1:

$$E = k(0.0032) \frac{\left(\frac{U}{5}\right)^{1.3}}{\left(\frac{M}{2}\right)^{1.4}}$$

Where:
 k=particle size multiplier
 U=average wind speed, mph
 M=material moisture content, %

TSP:

k = 0.74
 U = 11.0 mph (average wind speed for Sundance, WY)
 M = 0.7%

BLASTING EMISSIONS:

Emissions from blasting operations were calculated using AP-42 Table 13.3-1 and Table 11.9-1.

Emission Factors:

- NO_x: 17 lb/ton
- CO: 67 lb/ton
- SO₂: 2 lb/ton
- TSP: 0.000014(A)^{1.5} lb/blast
A = Horizontal area (ft²) = 2,500 ft²

Amount of Blasting Agent used: 8.0 TPY

$$\text{NO}_x \text{ Emissions} = 17 \frac{\text{lb}}{\text{ton}} \times 8.0 \frac{\text{ton}}{\text{year}} = 136.0 \frac{\text{lb}}{\text{year}} \times \frac{\text{ton}}{2,000\text{lb}} = 0.07 \frac{\text{ton}}{\text{year}}$$

$$\text{CO Emissions} = 67 \frac{\text{lb}}{\text{ton}} \times 8.0 \frac{\text{ton}}{\text{year}} = 536.0 \frac{\text{lb}}{\text{year}} \times \frac{\text{ton}}{2,000\text{lb}} = 0.27 \frac{\text{ton}}{\text{year}}$$

$$\text{SO}_2 \text{ Emissions} = 2 \frac{\text{lb}}{\text{ton}} \times 8.0 \frac{\text{ton}}{\text{year}} = 16 \frac{\text{lb}}{\text{year}} \times \frac{\text{ton}}{2,000\text{lb}} = 0.01 \frac{\text{ton}}{\text{year}}$$

TSP Emissions:

$$0.000014(A)^{1.5} \text{ lb/blast} = 0.000014(2,500)^{1.5} \text{ lb/blast} = 1.75 \text{ lb/blast}$$

$$\text{TSP Emissions} = 1.75 \frac{\text{lb}}{\text{blast}} \times 4 \frac{\text{blasts}}{\text{year}} = 7.0 \frac{\text{lb}}{\text{year}} \times \frac{\text{ton}}{2,000\text{lb}} = 0.004 \frac{\text{ton}}{\text{year}}$$

$$E = 0.74(0.0032) \frac{\left(\frac{11.0}{5}\right)^{1.3}}{\left(\frac{0.7}{2}\right)^{1.4}} = 0.03 \frac{lb}{ton}$$

$$\text{TSP Emissions} = \frac{107,000 \frac{ton}{year} \times 0.03 \frac{lb}{ton} \times (1-0.50)}{2,000 \frac{lb}{ton}} = 0.8 \frac{ton}{year} \times 2 \frac{drop}{trip} = 1.6 \frac{ton}{year} \text{ (50\% control)}$$

PM₁₀:

$$k = 0.35$$

U = 11.0 mph (average wind speed for Sundance, WY)

$$M = 0.7\%$$

$$E = 0.35(0.0032) \frac{\left(\frac{11.0}{5}\right)^{1.3}}{\left(\frac{0.7}{2}\right)^{1.4}} = 0.013 \frac{lb}{ton}$$

$$\text{PM}_{10} \text{ Emissions} = \frac{107,000 \frac{ton}{year} \times 0.013 \frac{lb}{ton} \times (1-0.50)}{2,000 \frac{lb}{ton}} = 0.35 \frac{ton}{year} \times 2 \frac{drop}{trip} = 0.7 \frac{ton}{year} \text{ (50\% control)}$$

control)

EXPOSED ACREAGE EMISSIONS:

Based on 8 acres exposed to wind erosion annually, TSP and PM₁₀ emissions were estimated as follows:

Exposed Acreage: TSP: 0.38 tons/acre/year, PM₁₀: 0.11 tons/acre/year
AP-42 Table 11.9-4

TSP Emissions = 8 acres x 0.38 tons/acre/year x (1-0.50) = 1.52 TPY (50% control)

PM₁₀ Emissions = 8 acres x 0.11 tons/acre/year x (1-0.50) = 0.44 TPY (50% control)

HAUL ROAD ACTIVITY EMISSIONS:

Fugitive TSP and PM₁₀ emissions per Vehicle Mile Traveled (VMT) associated with haul roads are estimated using AP-42 Chapter 13.2.2, equation (1a) as follows:

$$E = k \left(\frac{s}{12} \right)^a \left(\frac{W}{3} \right)^b$$

Where:

k=empirical constant

s=surface material silt content, %

a=empirical constant

W=mean vehicular weight

b=empirical constant

TSP:

$$k=4.9$$

$$s=8.3$$

$$a=0.7$$

$$W=17.0 \text{ tons}$$

$$b=0.45$$

$$E = 4.9 \left(\frac{8.3}{12} \right)^{0.7} \left(\frac{17.0}{3} \right)^{0.45} = 8.26 \frac{\text{lb}}{\text{VMT}}$$

Amount of trips per year:

$$100,000 \frac{\text{ton}}{\text{year}} \times \frac{1 \text{ trip}}{32.5 \text{ ton}} = 3,077 \frac{\text{trip}}{\text{year}}$$

$$\text{TSP Emissions} = 3,077 \frac{\text{trip}}{\text{year}} \times 3.0 \frac{\text{mile}}{\text{trip}} \times 8.26 \frac{\text{lb}}{\text{mile}} \times \frac{\text{ton}}{2,000 \text{ lb}} \times (1 - 0.50) = 19.1 \frac{\text{ton}}{\text{year}} \text{ (50\% control)}$$

PM₁₀:

$$k=1.5$$

$$s=8.3$$

$$a=0.9$$

$$W=17.0 \text{ tons}$$

$$b=0.45$$

$$E = 1.5 \left(\frac{8.3}{12} \right)^{0.9} \left(\frac{17.0}{3} \right)^{0.45} = 2.35 \frac{\text{lb}}{\text{VMT}}$$

Amount of trips per year:

$$100,000 \frac{\text{ton}}{\text{year}} \times \frac{1 \text{ trip}}{32.5 \text{ ton}} = 3,077 \frac{\text{trip}}{\text{year}}$$

$$\text{PM}_{10} \text{ Emissions} = 3,077 \frac{\text{trip}}{\text{year}} \times 3.0 \frac{\text{mile}}{\text{trip}} \times 2.35 \frac{\text{lb}}{\text{VMT}} \times \frac{\text{ton}}{2,000 \text{ lb}} \times (1 - 0.50) = 5.42 \frac{\text{ton}}{\text{year}} \text{ (50\% control)}$$

DEPARTMENT OF ENVIRONMENTAL QUALITY
AIR QUALITY DIVISION

Permit Application Analysis
AP-5468

January 2, 2006

NAME OF FIRM: Croell Redi Mix, Inc.
NAME OF MINE: Roger's Rock Pit
LOCATION OF MINE: NW¼ NE¼ of Section 25, T52N, R62W
Crook County, Wyoming
TYPE OF OPERATION: Limestone Mine
RESPONSIBLE OFFICIAL: Julie Ewing, Health and Safety Director
MAILING ADDRESS: P.O. Box 1352
Sundance, WY 82729
TELEPHONE NUMBER: 307-283-2221
REVIEWING ENGINEER: Rita Piroutek, Air Quality Specialist
PURPOSE OF APPLICATION:

The Division of Air Quality has reviewed your application received October 23, 2006 to construct the Roger's Rock Pit and proposed portable crushing/screening plant, to be initially located in the NW¼ NE¼ of Section 25, T52N, R62W, approximately 5 miles northeast of Sundance, in Crook County, Wyoming. The Division is proposing to issue separate permits for the pit and crushing/screening equipment.

PROPOSED CRUSHING/ SCREENING EQUIPMENT:

- Telsmith, model#30x40, Serial# 505M1761C56 (primary crusher)
- Sandvik model # H48800, Serial # 441382100 (secondary crusher)
- Cedar Rapids model # 6x20, Serial # 46509 (primary screen)
- Cedar Rapids model # TSS6203, Serial # 52059 (secondary screen)
- 250 hp Caterpillar Model # D200P3, Serial # 200TG3127 (generator)

REPORTED QUARRY INFORMATION:

Annual Production Rate: 100,000 tons
 Material Mined: Limestone
 Size of Mine: 10 acres
 Operation: crushing and screening, stockpiling, blasting
 # of Blasts per Year: 4
 Distance to Nearest Residence: 1 mile
 Number of Residences within 1 mile radius: 1
 Distance Material Hauled Until Reaching Pavement: 1.5 miles
 Proper Land Use Documentation Submitted: yes
 A facility location map is included as Appendix A.

The pollutant of main concern at the Roger's Rock Pit operation will be fugitive particulate matter emitted primarily from crushing, screening, stockpiling, haul truck activity, exposed acreage, and the diesel engine used to power the crusher/screening operation. The Division estimated emission based on EPA document, AP-42, Compilation of Emission Factors. Table 1 and 2 shows emissions from the generator engine that powers the crushing/screening equipment. Table 3 lists the estimated emissions for crushing and screening based on 100,000 tpy mined material, fifteen conveyor transfer points, stockpiling based on 100,000 tpy of mined material, 2,000 tpy of topsoil, and 5,000 tpy overburden, exposed acreage is based on 8 acres. Application of water during crushing/screening and stockpiling operations is credited for 50% control efficiency. Table 4 lists emissions from haul road activities based on a haul road length of 3.0 mile (total miles to and from the pit). Emission calculations are detailed in Appendix B.

Engine	hp	Controls	NO _x	CO	SO ₂	VOC	PM
Caterpillar Model # D200P3	250	Tier I Certified	6.9	8.5	0.02	1.0	0.4

Source	NO _x		CO		SO ₂		VOC		PM	
	lb/hr	tpy	lb/hr	tpy	lb/hr	tpy	lb/hr	tpy	lb/hr	tpy
Caterpillar D200P3	3.8	1.9	4.7	2.3	<0.1	<0.1	0.6	0.3	0.2	0.1

¹ Emissions estimated to nearest 0.1
² TPY based on 1000 hours per year

Source	NO _x	CO	SO ₂	TSP	PM ₁₀
Crushing	-	-	-	0.1	0.1
Screening	-	-	-	0.6	0.2
Conveyor Transfer Points	-	-	-	1.4	0.2
Stockpiling	-	-	-	1.6	0.7

Exposed Acreage				1.5	0.4
Blasting	0.1	0.3	<0.1	<0.1	-
Caterpillar D200P3	1.9	2.3	<0.1	0.1	0.1
Total Emissions	2.0	2.6	<0.1	5.3	1.7

¹Emissions estimated to nearest 0.1

Source	TSP	PM ₁₀
Haul Road	19.1	5.4

BEST AVAILABLE CONTROL TECHNOLOGY (BACT):

The Division considers the use of water and/or chemical dust suppressants on the work areas, access roads, and haul roads to represent BACT for this type of operation. Since the materials production site has a production rate of 100,000 tons per year, the Division will require water or dust suppressant applications sufficient to control fugitive dust for the haul route from the pit to Frontage Road (Highway 14).

BACT for crushing/screening operations shall consist of a wet suppression system in use at all times the crushing/screening equipment is in use. The wet suppression system shall be located at all belt transfer points, screens and the inlet-outlet of crushers to the extent necessary to achieve control of fugitive dust emissions.

The generator will be Tier I certified. The Division considers Tier I certification as representing BACT.

CHAPTER 6, SECTION 3 APPLICABILITY:

The Roger's Rock Pit is not a "major source" as defined by Chapter 6, Section 3 of the Wyoming Air Quality Standards and Regulations (WAQSR). Emissions do not exceed the 100 tpy threshold of any regulated pollutant.

NEW SOURCE PERFORMANCE STANDARDS (NSPS):

The Roger's Rock Pit has a maximum production rate of 300 tons per hour. Therefore, crushing/screening equipment located at this site will be subject to 40 CFR, Part 60, Subpart OOO - Standards of Performance for Nonmetallic Mineral Processing Plants, if it is constructed, reconstructed or modified after August 31, 1983 and has a capacity greater than 150 tons per hour. This regulation limits opacity to 15% from crushers and to 10% from all other affected sources (screens, conveyors).

PREVENTION OF SIGNIFICANT DETERIORATION (PSD):

The proposed limestone quarry is not a "major emitting facility" as defined by Chapter 6, Section 4 of the Wyoming Air Quality Standards and Regulations. Therefore, further analysis is not required under this section.

AMBIENT AIR QUALITY:

It is the Division's experience that ambient air quality standards will be maintained with the utilization of the control measures recognized as BACT for quarry operations.

PROPOSED PERMIT CONDITIONS:

The Division is proposing to issue Air Quality Permits to Croell Redi Mix, Inc. for the Roger's Rock Pit and the crushing and screening equipment subject to the following conditions:

1. Authorized representatives of the Division of Air Quality shall be given permission to enter and inspect any property, premise or place on or at which an air pollution source is located or is being constructed or installed for the purpose of investigating actual or potential sources of air pollution, and for determining compliance or non-compliance with any rules, standards, permits or orders.
2. All substantive commitments and descriptions set forth in the application for this permit, unless superseded by a specific condition of this permit, are incorporated herein by this reference and are enforceable as conditions of this permit.
3. All notifications, reports and correspondence associated with this permit shall be submitted to the Stationary Source Compliance Program Manager, Air Quality Division, 122 West 25th Street, Cheyenne, WY 82002 and a copy shall be submitted to the District Engineer, Air Quality Division, 1866 South Sheridan Ave., Sheridan, WY 82801.
4. The owner or operator shall furnish the Administrator written notification of: (i) the anticipated date of initial startup not more than 60 days or less than 30 days prior to such date, and; (ii) the actual date of initial start-up within 15 days after such date in accordance with Chapter 6, Section 2(i) of the WAQSR.
5. The date of commencement of construction shall be reported to the Administrator within 30 days of such date. The permit shall become invalid if construction or modification is not commenced within 24 months of the date of permit issuance or if construction is discontinued for a period of 24 months or more in accordance with Chapter 6, Section 2(h) of the WAQSR. The Administrator may extend such time period(s) upon a satisfactory showing that an extension is justified.
6. Any crushing/screening, hot mix plant or concrete batch plant equipment shall have separate valid air quality permit(s) prior to locating/operating at this site.
7. Any crushing/screening equipment operated at this site shall utilize water spray control measures at all belt transfer points, screens, and discharge points of the crushers as necessary to limit visible emissions to twenty (20) percent opacity or applicable limits set forth by Wyoming Air Quality Standards and Regulations, Chapter 5, Section 2, Subpart OOO, as determined by 40 CFR, Part 60, Appendix A, Method 9.
8. That all work areas, disturbed areas, and stockpiles shall be treated with water and/or chemical

dust suppressants on a schedule sufficient to control fugitive dust.

9. The haul roads extending from the pit to Frontage Road (Highway 14) shall be treated with water and/or chemical dust suppressants on a schedule sufficient to control fugitive dust from vehicular traffic.

CONDITIONS FOR PORTABLE CRUSHING/SCREENING EQUIPMENT (SUBJECT TO SUBPART 000):

1. That authorized representatives of the Division of Air Quality be given permission to enter and inspect any property, premise or place on or at which an air pollution source is located or is being installed for the purpose of investigating actual or potential sources of air pollution and for determining compliance or non-compliance with any rules, regulations, standards, permits or orders.
2. That all substantive commitments and descriptions set forth in the application for this permit, unless superseded by a specific condition of this permit, are incorporated herein by this reference and are enforceable as conditions of this permit.
3. That all notifications, reports and correspondences associated with this permit shall be submitted to the Stationary Source Compliance Program Manager, Air Quality Division, 1866 South Sheridan Ave., Sheridan, WY 82801.
4. That all unpaved portions of the haul roads, access roads, work areas and stockpiles associated with this plant shall be treated with water and/or chemical dust suppressants on a schedule sufficient to control fugitive dust emissions from vehicular traffic and wind erosion.
5. That the allowable opacity for fugitive emissions associated with the crusher shall be limited to 15%, the allowable opacity for the screen, conveyor transfer points and other fugitive emission points shall be limited to 10% as determined by 40 CFR, Part 60, Appendix A, Method 9.
6. That the crushing/screening plant shall utilize a wet suppression system at all times the crushing/screening plant is in use. The wet suppression system shall be located at all belt transfer points and discharge points off the crushers/screens and operated to the extent necessary to achieve the allowable opacity limits established in Condition #5.
7. That Croell Redi Mix shall comply with all applicable requirements of 40 CFR, Part 60, Subpart 000.
8. In accordance with Chapter 6, Section 2(b)(ii) of the WAQSR, Croell Redi Mix shall submit a "self-issuance" relocate permit for each new location. Such permit shall be executed and copies provided to the Air Quality Division prior to operation at the new location. A fee will be assessed upon issuance of the relocation permit.
9. Croell Redi Mix shall keep a copy of the permit and the relocation permit with the crushing/screening equipment at all times.

10. Croell Redi Mix shall document that the 250 hp Caterpillar generator is Tier I certified.



Department of Environmental Quality



To protect, conserve and enhance the quality of Wyoming's environment for the benefit of current and future generations.

Dave Freudenthal, Governor

John Corra, Director

January 3, 2007

Sundance Times
P.O. Box 400
Sundance, WY 82720

Enclosed is a copy of **one** public notice that must be published in your newspaper one time only on **Thursday, January 11, 2007**. Please note that the legal descriptions contained within this notice are extremely important. They require special attention during proofreading. If this date cannot be met, please call me at 777-7340. Please send a copy of your Affidavit of Publication and invoice for processing. It is very important that we receive this affidavit as soon as possible after the issue date.

Thank you for your assistance in this matter.

Sincerely,

Gail B. Eckert
Administrative Specialist
Air Quality Division

Enclosure



STATE OF WYOMING

Department of Environmental Quality/Division of Air Quality

PUBLIC NOTICE

Chapter 6, Section 2(m) of the Wyoming Air Quality Standards and Regulations provides that prior to final determination on an application to construct a new source, opportunity be given for public comment and/or public hearing on the information submitted by the owner or operator and on the analysis underlying the proposed approval or disapproval. The regulation further requires that such information be made available in at least one location in the affected air quality control region, and that the public be allowed a period of thirty (30) days in which to submit comments. A public hearing will be conducted only if in the opinion of the administrator sufficient interest is generated or if an aggrieved party so requests.

Notice is hereby given that the State of Wyoming, Department of Environmental Quality, Division of Air Quality, proposes to approve a request by the following applicant to construct a new source in Crook County, Wyoming.

Croell Redi-Mix
PO Box 1352
Sundance, WY 82729

The applicant has requested permission to construct a limestone mine, known as the Roger's Rock Pit, with an annual production rate of 100,000 tons, and a portable crushing/screening plant to be initially located at the pit in the NW1/4 NE1/4 of Section 25, T52N, R62W, approximately 5 miles northeast of Sundance, in Crook County, Wyoming. A copy of the permit application and the agency's analysis is available for public inspection at the Crook County Clerk's Office, Sundance, Wyoming. In accordance with the

Americans with Disabilities Act, special assistance or alternate formats will be made available upon request for individuals with disabilities.

Comments may be directed to David A. Finley, Administrator, Division of Air Quality, Department of Environmental Quality, 122 W. 25th St., Cheyenne, Wyoming 82002. All comments received by 5:00 p.m., Monday, February 12, 2007, will be considered in the final determination on this application.

FILED

OCT 29 2010

Exhibit 17

Jim Ruby, Executive Secretary
Environmental Quality Council

EQC Docket 10-2803

Judith Bush

Croell Redi-Mix AQD Permit CT-4526

**This permit application was originally filed as AP 5468 -
see exhibit 16 above**

**This is an AQD mine permit for a 10 acre minesite
with a maximum production of 100,000 tons per year.**

**It is the permit under which all crusher / operator permits
were issued until MN 9645 was approved on March 17, 2010.**



75

Department of Environmental Quality



To protect, conserve and enhance the quality of Wyoming's environment for the benefit of current and future generations.

Steve Freudenthal, Governor

John Corra, Director

February 13, 2007

Ms. Julie Ewing
Health & Safety Director
Croell Redi-Mix
PO Box 1352
Sundance, WY 82729

Permit No. CT-4526



Dear Ms. Ewing:

The Division of Air Quality of the Wyoming Department of Environmental Quality has completed final review of Croell Redi-Mix's application to construct a limestone mine, known as the Roger's Rock Pit, with an annual production rate of 100,000 tons located in the NW1/4 NE1/4 of Section 25, T52N, R62W, approximately 5 miles northeast of Sundance, in Crook County, Wyoming.

Following this agency's proposed approval of the request as published January 11, 2007 and in accordance with Chapter 6, Section 2(m) of the Wyoming Air Quality Standards and Regulations, the public was afforded a 30-day period in which to submit comments concerning the proposed new source, and an opportunity for a public hearing. No comments have been received. Therefore, on the basis of the information provided to us, approval to construct the Rogers Rock Pit as described in the application is hereby granted pursuant to Chapter 6, Section 2 of the regulations with the following conditions:

1. That authorized representatives of the Division of Air Quality be given permission to enter and inspect any property, premise or place on or at which an air pollution source is located or is being constructed or installed for the purpose of investigating actual or potential sources of air pollution and for determining compliance or non-compliance with any rules, standards, permits or orders.
2. That all substantive commitments and descriptions set forth in the application for this permit, unless superseded by a specific condition of this permit, are incorporated herein by this reference and are enforceable as conditions of this permit.
3. All notifications, reports and correspondence associated with this permit shall be submitted to the Stationary Source Compliance Program Manager, Air Quality Division, 122 West 25th Street, Cheyenne, WY 82002 and a copy shall be submitted to the District Engineer, Air Quality Division, 1866 South Sheridan Ave., Sheridan, WY 82801.
4. The owner or operator shall furnish the Administrator written notification of: (i) the anticipated date of initial startup not more than 60 days or less than 30 days prior to such date, and; (ii) the actual date of initial start-up within 15 days after such date in accordance with Chapter 6, Section 2(i) of the WAQSR.

Superseded
019645



FILED

OCT 29 2010

Jim Ruby, Executive Secretary
Environmental Quality Council

Exhibit 18

**EQC Docket 10-2803
Judith Bush**

Croell Redi-Mix AQD Permit CT-4527

This permit application was originally filed as AP 5468 - see exhibit 16

**This is The crusher / operator permit issued at the same time
as the mine permit CT-4526 (Exhibit 18 above)**

Like CT-4526, it notes a maximum production of 100,000 tons per year.

**This permit was superseded by MD 8685 (Exhibit 20), but Croell
later requested that it be added to MD 8685 instead. *pages 6 - 11***



Department of Environmental Quality



To protect, conserve and enhance the quality of Wyoming's environment for the benefit of current and future generations.

Jave Freudenthal, Governor

John Corra, Director

February 13, 2007

Ms. Julie Ewing
Health & Safety Director
Croell Redi-Mix
PO Box 1352
Sundance, WY 82729

Permit No. CT-4527

Dear Ms. Ewing:

The Division of Air Quality of the Wyoming Department of Environmental Quality has completed final review of Croell Redi-Mix's application for a portable crushing/screening plant to be initially located at the Roger's Rock Pit in the NW1/4 NE1/4 of Section 25, T52N, R62W, approximately 5 miles northeast of Sundance, in Crook County, Wyoming.

The portable crushing and screening equipment consists of the following:

- Telsmith, model#30x40, Serial# 505M1761C56 (primary crusher)
- Sandvik model # H48800, Serial # 441382100 (secondary crusher)
- Cedar Rapids model # 6x20, Serial # 46509 (primary screen)
- Cedar Rapids model # TSS6203, Serial # 52059 (secondary screen)
- 250 hp Caterpillar Model # D200P3, Serial # 200TG3127 (generator)

Following this agency's proposed approval of the request as published January 11, 2007, and in accordance with Chapter 6, Section 2(m) of the Wyoming Air Quality Standards and Regulations, the public was afforded a 30-day period in which to submit comments concerning the proposed new source, and an opportunity for a public hearing. No comments have been received. Therefore, on the basis of the information provided to us, approval to operate crushing and screening equipment as described in the application is hereby granted pursuant to Chapter 6, Section 2 of the regulations with the following conditions:

1. That authorized representatives of the Division of Air Quality be given permission to enter and inspect any property, premise or place on or at which an air pollution source is located or is being constructed or installed for the purpose of investigating actual or potential sources of air pollution and for determining compliance or non-compliance with any rules, standards, permits or orders.
2. That all substantive commitments and descriptions set forth in the application for this permit, unless superseded by a specific condition of this permit, are incorporated herein by this reference and are enforceable as conditions of this permit.
3. That all notifications, reports and correspondences associated with this permit shall be submitted to the Stationary Source Compliance Program Manager, Air Quality Division, 1866 South Sheridan Ave., Sheridan, WY 82801.

4. That all unpaved portions of the haul roads, access roads, work areas and stockpiles associated with this plant shall be treated with water and/or chemical dust suppressants on a schedule sufficient to control fugitive dust emissions from vehicular traffic and wind erosion.
5. That the allowable opacity for fugitive emissions associated with the crusher shall be limited to 15%, the allowable opacity for the screen, conveyor transfer points and other fugitive emission points shall be limited to 10% as determined by 40 CFR, Part 60, Appendix A, Method 9.
6. That the crushing/screening plant shall utilize a wet suppression system at all times the crushing/screening plant is in use. The wet suppression system shall be located at all belt transfer points and discharge points off the crushers/screens and operated to the extent necessary to achieve the allowable opacity limits established in Condition #5.
7. That Croell Redi Mix shall comply with all applicable requirements of 40 CFR, Part 60, Subpart 000.
8. In accordance with Chapter 6, Section 2(b)(ii) of the WAQSR, Croell Redi Mix shall submit a "self-issuance" relocate permit for each new location. Such permit shall be executed and copies provided to the Air Quality Division prior to operation at the new location. A fee will be assessed upon issuance of the relocation permit.
9. Croell Redi Mix shall keep a copy of the permit and the relocation permit with the crushing/screening equipment at all times.
10. Croell Redi Mix shall document that the 250 hp Caterpillar generator is Tier I certified.

It must be noted that this approval does not relieve you of your obligation to comply with all applicable county, state, and federal standards, regulations or ordinances. Special attention must be given to Chapter 6, Section 2 of the Wyoming Air Quality Standards and Regulations. Any appeal of this permit as a final action of the Department must be made to the Environmental Quality Council within sixty (60) days of permit issuance per Section 16, Chapter I, General Rules of Practice and Procedure, Department of Environmental Quality.

If we may be of further assistance to you, please feel free to contact this office.

Sincerely,

David A. Finley
Administrator
Air Quality Division

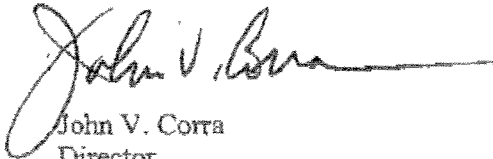
John V. Corra
Director
Dept. of Environmental Quality

cc: Mike Warren

Table 1: Diesel Engine Emission Factors (g/hp-hr)							
Engine	hp	Controls	NO _x	CO	SO ₂	VOC	PM
Caterpillar Model # D200P3	250	Tier I Certified	6.9	8.5	0.02	1.0	0.4

Table 2: Diesel Engine Emissions Summary										
Source	NO _x		CO		SO ₂		VOC		PM	
	lb/hr	tpy	lb/hr	tpy	lb/hr	tpy	lb/hr	tpy	lb/hr	tpy
Caterpillar D200P3	3.8	1.9	4.7	2.3	<0.1	<0.1	0.6	0.3	0.2	0.1

¹Emissions estimated to nearest 0.1
²TPY based on 1000 hours per year

Permit #

A No 05481
Number

State of Wyoming
Division of Air Quality
Portable Facility Relocate/Operate Permit

Name of Firm: Croell Ledi Mix Inc.

Address: PO Box 1352 Sundance, WY 82729

Telephone No.: 307-283-2221 Current Air Quality Permit No. CT4527

Description of equipment included under permit: TelSmith Crusher, Sandvic
Crusher, 2 Cedar rapids screens, 250 hp. Caterpillar generator

Location of Operations: NENE 1/4 Section 25 Township 24

North, Range 69 West, County Platte Other (Highway Milepost,

Town, Pit Name, etc.) IN Wheatland, WY:

Duration of Operations at Location: 6 months

Start Date at New Location: approximately May 15, 2008

Production Rate: Tons per hour 300 TONS

Total production at new location 300,000 TONS

Comments:

Certification

I hereby certify that:

1. The new location is not a new source as defined in Section 21.b (ii) of the Wyoming Air Quality Standards and Regulations.
2. A current Air Quality Permit is in effect for the above described equipment.
3. Air pollution control equipment as described in a permit application on file with, or as specified in previous permits issued by the Air Quality Division will be operated at all times during process equipment operation.

Signature [Signature] Typed Name Julie Ewing

Title Health + Safety Dir.

Original & yellow copy to: DEQ, Air Quality Division
Retain pink copy. 122 W. 25th Street
Cheyenne, Wyoming 82002

Page 5 5-14-09 55

Permitted

A No 05484
Number

State of Wyoming
Division of Air Quality
Portable Facility Relocate/Operate Permit

Name of Firm: Croell Ledi Mix Inc.

Address: PO Box 1352 Sundance, WY 82721

Telephone No.: 307-283-2221 Current Air Quality Permit No. CT4527

Description of equipment included under permit: Cedar Lapis Screen Plant, affiliated conveyors, sandmill/crusher

Location of Operations: W 1/2 1/4 Section 10 Township 31

North, Range 70 West, County CONVERSE Other (Highway Milepost,

Town, Pit Name, etc.) Douglas, WY - Carmin Pit

Duration of Operations at Location: ~ 6 mos.

Start Date at New Location: w/ Sept 1, 2009 (approx date)

Production Rate: Tons per hour 300 TONS Max.

Total production at new location 60 - 80,000.

Comments:

Certification

I hereby certify that:

- 1. The new location is not a new source as defined in Section 21.b (ii) of the Wyoming Air Quality Standards and Regulations.
- 2. A current Air Quality Permit is in effect for the above described equipment.
- 3. Air pollution control equipment as described in a permit application on file with, or as specified in previous permits issued by the Air Quality Division will be operated at all times during process equipment operation.

Signature Julie Ewing Typed Name Julie Ewing
Title Health + Safety Director

Original & yellow copy to: DEQ, Air Quality Division
Retain pink copy. 122 W. 25th Street
Cheyenne, Wyoming 82002

8-18-09
JS
Page 6



Department of Environmental Quality



To protect, conserve and enhance the quality of Wyoming's environment for the benefit of current and future generations.

Dave Freudenthal, Governor

John Corra, Director

January 21, 2009

Ms. Julie Ewing
Health & Safety Director
Croell Redi-Mix
PO Box 1352
Sundance, WY 82729

Permit No. MD-8685

Dear Ms. Ewing:

The Division of Air Quality of the Wyoming Department of Environmental Quality has completed final review of Croell Redi-Mix's application to modify portable crushing/screening and conveyor equipment to be initially located at the Roger's Rock Pit in the NW1/4NE1/4 of Section 25, T52N, R62W, approximately eight (8) miles east-northeast of Sundance, in Crook County, Wyoming. Maximum production for the crushing and conveyor equipment is reported at 400,000 tons per year (tpy) and 350 tons per hour (tph).

Following this agency's proposed approval of the request as published December 18, 2008 and in accordance with Chapter 6, Section 2(m) of the Wyoming Air Quality Standards and Regulations, the public was afforded a 30-day period in which to submit comments concerning the proposed modification, and an opportunity for a public hearing. No comments have been received. Therefore, on the basis of the information provided to us, approval to modify the Roger's Rock Pit as described in the application is hereby granted pursuant to Chapter 6, Section 2 of the regulations with the following conditions:

1. That authorized representatives of the Division of Air Quality be given permission to enter and inspect any property, premise or place on or at which an air pollution source is located or is being constructed or installed for the purpose of investigating actual or potential sources of air pollution and for determining compliance or non-compliance with any rules, standards, permits or orders.
2. That all substantive commitments and descriptions set forth in the application for this permit, unless superseded by a specific condition of this permit, are incorporated herein by this reference and are enforceable as conditions of this permit.
3. That all notifications, reports and correspondences associated with this permit shall be submitted to the Stationary Source Compliance Program Manager, Air Quality Division, 122 West 25th Street, Cheyenne, WY 82002.
4. That the allowable opacity for fugitive emissions associated with the crushing/screening equipment shall be limited to 15%, the allowable opacity for screen, conveyor transfer points and other fugitive emission points shall be limited to 10% as determined by 40 CFR, part 60, Appendix A, Method 9.

Herschler Building • 122 West 25th Street • Cheyenne, WY 82002 • <http://deq.state.wy.us>

ADMIN/OUTREACH (307) 777-7937 FAX 777-3610	ABANDONED MINES (307) 777-6145 FAX 777-6462	AIR QUALITY (307) 777-7391 FAX 777-5616	INDUSTRIAL SITING (307) 777-7369 FAX 777-5973	LAND QUALITY (307) 777-7756 FAX 777-5864	SOLID & HAZ. WASTE (307) 777-7752 FAX 777-5973	WATER QUALITY (307) 777-7781 FAX 777-5973
--	---	---	---	--	--	---



5. That the crushing/screening equipment shall be equipped with a wet suppression system to control fugitive emissions from the crushing/screening equipment. The wet suppression system shall operate to the extent necessary comply with the allowable opacity limits established in condition 4.
6. That all unpaved portions of the haul roads, access roads, work areas and stockpiles associated with this crushing/screening equipment shall be treated with water and/or chemical dust suppressants on a schedule sufficient to control fugitive dust from vehicular traffic and wind erosion.
7. That Croell Redi-Mix shall comply with all applicable requirements of 40 CFR part 60, subpart 000.
8. Croell Redi-Mix shall document that the 250 hp Caterpillar generator is Tier I certified.
9. In accordance with Chapter 6, Section 2(b)(ii) of the WAQSR, Croell Redi Mix shall submit a "self-issuance" relocate permit for each new location. Such permit shall be executed and copies provided to the Air Quality Division prior to operation at the new location. A fee will be assessed upon issuance of the relocation permit.
10. Croell Redi Mix shall keep a copy of the permit, the relocation permit, and the Tier I certification for the 250 hp Caterpillar generator with the crushing/screening equipment at all times.
11. This permit shall supersede Air Quality Permit CT-4527.

It must be noted that this approval does not relieve you of your obligation to comply with all applicable county, state, and federal standards, regulations or ordinances. Special attention must be given to Chapter 6, Section 2 of the Wyoming Air Quality Standards and Regulations, which details the requirements for compliance with condition 9. Any appeal of this permit as a final action of the Department must be made to the Environmental Quality Council within sixty (60) days of permit issuance per Section 16, Chapter I, General Rules of Practice and Procedure, Department of Environmental Quality.

If we may be of further assistance to you, please feel free to contact this office.

Sincerely,

David A. Finley
Administrator
Air Quality Division

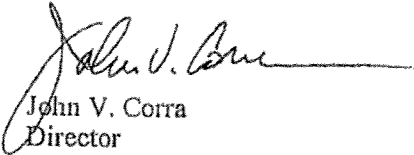
John V. Corra
Director
Dept. of Environmental Quality

cc: Tanner Shatto

Source	TSP	PM ₁₀	NO _x	CO	SO _x
Metso NP1415 Primary Impact Crusher (SN-20670118)	0.5	0.2	--	--	--
Two (2) Conveyor Transfer/Drop Points	0.6	0.2	--	--	--
Total Emissions	1.1	0.4	--	--	--

¹ Emissions estimated to nearest 0.1 ton



2719 South Hwy 585
P.O. Box 1352
Sundance, Wyoming 82729
Phone: 307-283-2221
Fax: 307-283-1450

June 30, 2009



WYDEQ/Air Quality
ATTN: Chad Schlichtemeier
Herschler Building
122 West 25th Street
Cheyenne, WY 82002

RE: AIR QUALITY PERMIT #MD-8685

Dear Mr. Schlichtemeier:

On January 21, 2009 Croell Redi-Mix, Inc. received air quality permit MD-8685. In a recent field inspection it was brought to our attention that this particular permit superseded air quality permit CT-4527. Our intention of the application for air quality permit #MD-8685 was only to add a secondary crusher to the existing spread of equipment we had permitted as CT-4527. Does condition number eleven in permit MD-8685, which states, "This permit shall supersede Air Quality Permit CT-4527," remove our air quality for the equipment permitted by CT-4527 or does this new permit encompass all equipment. Our intention is to hold two separate air quality permits so both crushers can operate simultaneously.

Could you please look into this at your earliest convenience and let me know what steps I need to take to clear this situation up? Thank you for your help and please do not hesitate to contact me at the above address should you have any questions or concerns regarding this matter.

Sincerely,

A handwritten signature in black ink, appearing to read "Julie Ewing".

Julie Ewing
Health and Safety Director
Croell Redi-Mix, Inc.

Cc: Tanner Shatto



Department of Environmental Quality



To protect, conserve and enhance the quality of Wyoming's environment for the benefit of current and future generations.

ve Freudenthal, Governor

John Corra, Director

September 3, 2009

Ms. Julie Ewing
Health & Safety Director
Croell Redi-Mix
PO Box 1352
Sundance, WY 82729

Permit No. **MD-8685 (Corrected)**

Dear Ms. Ewing:

Enclosed is the corrected permit referenced above for portable crushing/screening and conveyor equipment to be initially located at the Roger's Rock Pit in the NW1/4NE1/4 of Section 25, T52N, R62W, approximately eight (8) miles east-northeast of Sundance, in Crook County, Wyoming.

By letter dated June 30, 2009, Croell Redi-Mix requested to correct Air Quality Permit MD-8685 to include the existing equipment from Air Quality Permit CT-4527. It was not the Division's intent to only include the Metso NP1415 primary impact crusher (SN:20670118) and two (2) conveyor transfer/drop points in Air Quality Permit MD-8685. Therefore, the Division has corrected Air Quality Permit MD-8682 to include the previously permitted equipment from Air Quality Permit CT-4527.

If we may be of further assistance to you, please feel free to contact this office.

Sincerely,

David A. Finley
Administrator
Air Quality Division

cc: Tanner Shatto

