

Legend

- HJ Monitor Well
- Drawdown Contour (feet)
- - - Lost Creek Fault

Scale: 1:2,000

Lost Creek ISR, LLC
 Littleton, Colorado, USA
 RECEIVED
 MAY 22 2009
 WDEQ/LDD
 www.petrotek.com
 Littleton, CO USA

FIGURE D6-15
 Drawdown in the HJ Aquifer
 at the End of the LC19M
 Pumping Test (2007)
 Lost Creek Permit Area

Issued For: WDEQ-LDD 1.0
 Issued/ Revised: 04.13.09
 Drawing No.: WDEQ_LDD_FIG_D6-15.mxd
 Drawn By: JIM

0 150 300 Feet

Projection: NAD 27 StatePlane Wyoming West Central (feet)

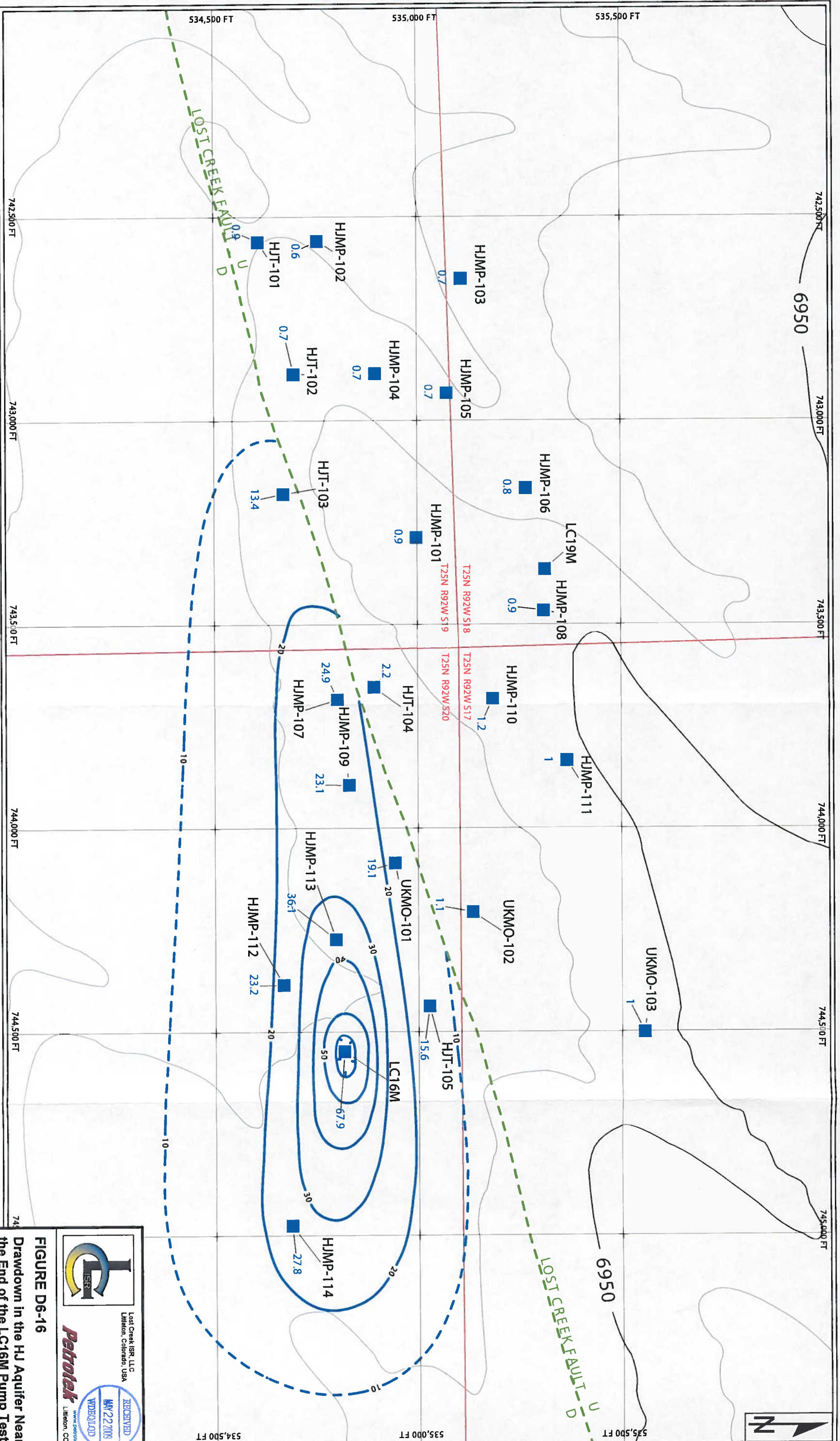

FIGURE D6-16

Drawdown in the HJ Aquifer Near
the End of the LC16M Pump Test
Lost Creek Permit Area

4/9/08

Issued For: WDEQ-LQD 1.0
Issued/ Revised: 05.01.09
Drawn By: JM

Drawing No.: WDEQ-LQD_Fig_D6-16.ai



Lost Creek ISR, LLC
Littleton, Colorado USA



RECEIVED
MAY 22 2009
WDEQ/LQD
www.petrotek.com
Littleton, CO USA